

GGX7s Grease Guardian 230 VAC Specification c/w Frame

Front View

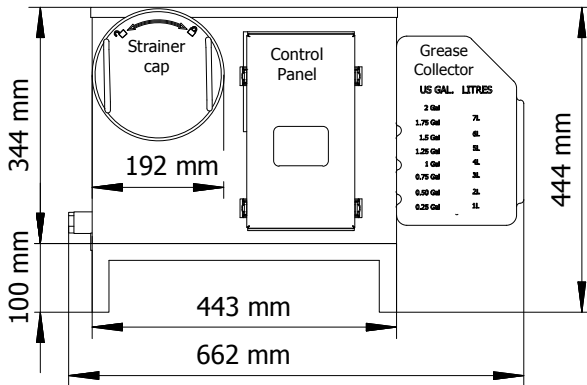

Right End View

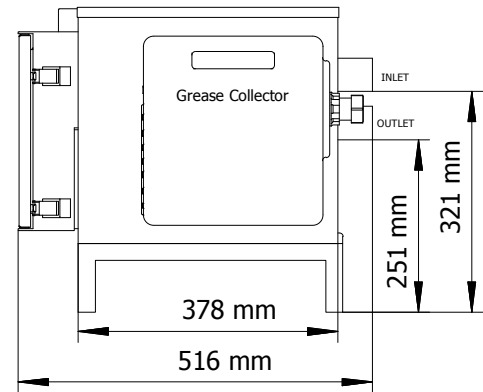

Attention: The support frame (included) must be installed for all model GGX7s applications

Footprint/Containment area

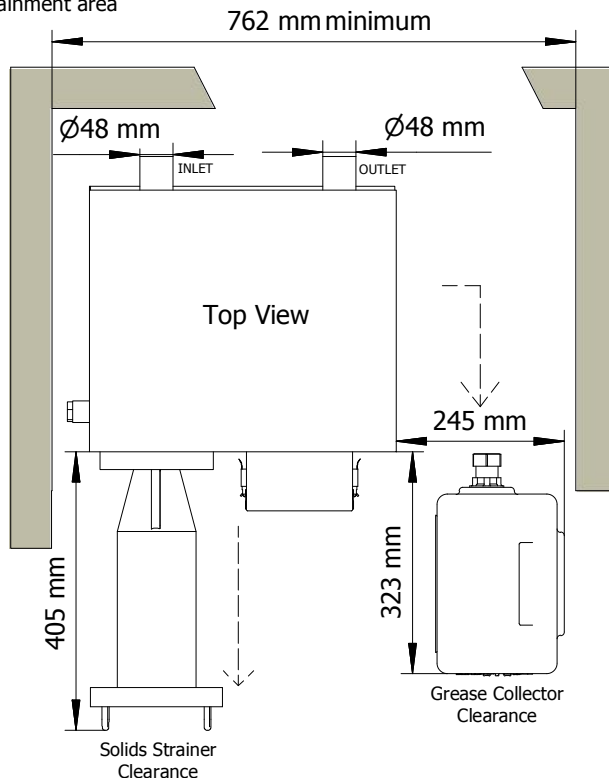

Standard Features

- Automatic grease removal mechanism
- Internal dry solids strainer
- Support frame, to achieve specified gravity flow.
- Grease heating system
- PLC controller with LCD notifications
- Energy saving mode
- Building Management Control(zero volt contact for power status)
- Bidirectional Inlet and Outlet plumbing ports
- Quick Fit rubber couplings
- Pipework and power cabling concealed at rear.
- 3 year guarantee

Exclusions:

- RCD, IP socket, or any electrical supply devices beyond mains cord/plug as supplied.
- Pipework beyond inlet/outlet couplings /ventilation piping

Options: by FM Environmental on request:

- Upstream coarse solids strainer modules
- Upgrade to internal automatic spraybar system
- Externally mounted blower system (for surface scum dispersal)
- Sample valve (150mm additional length in outlet pipework required)

Key Installation Notes:

Allow for the minimum clearances shown, including clearance for pipe connections and user access to front of unit

Unit should be plumbed at a gravity fall (1:40 for maximum performance)

Control panel should be fully accessible to service personnel

Electrical supply is single phase. An RCD/ELCB rated 30mA must be installed for all Grease Guardian electrical supplies

Observe all local plumbing regulations for pipe venting, trapping.
Observe all local safety and hygiene regulations

Note: Not to be treated as an installation guide. Installation guide in full is issued on supply of system.

TECHNICAL DATA

Weight	35 kg (empty)
Material	Exterior, 16 gauge stainless steel, bright finish
Interior	Stainless Steel and Acetal Plastic Components
Tank Capacity	25 litres
Maximum Flow Rate	0.5Litres per Second
Tank grease Retention Capacity	15 pounds/6.8kg
Solid Strainer Capacity	6.6 pounds/2.99 kg
Skimming Rate	5 litres per hour
Programing/Contro	24 hour, 7 day, multi functional digital
Electrical Load	230VAC, 625Watts, 2.72 AMPS