

# Mid West Native Garden Design

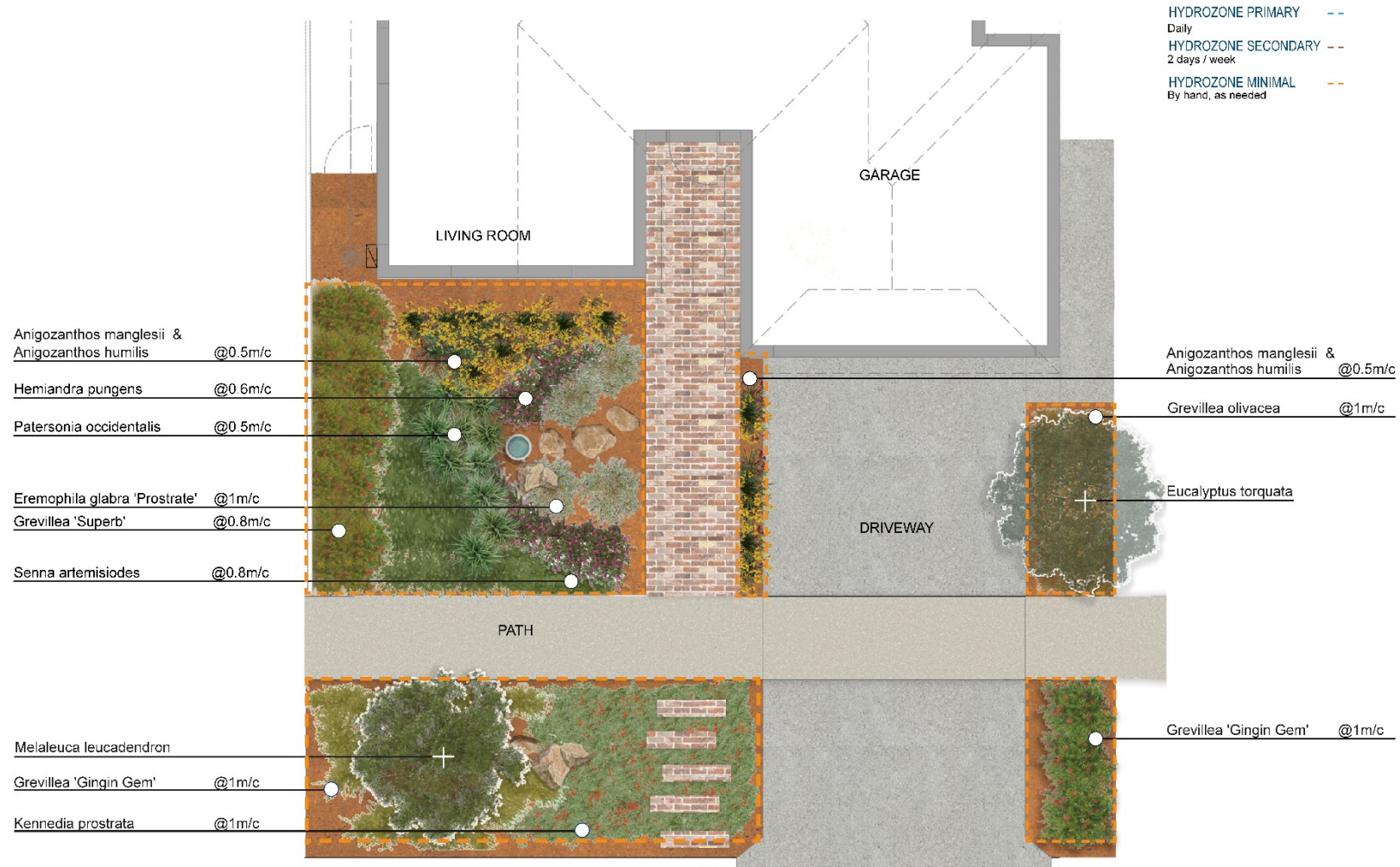

Note: m/c refers to the planting density ie 0.6m/c - leave 0.6 metre space between the centre stem of each of plant

## Mid West Native Garden Design

<b>Supplies</b>	<b>Plant Directory</b>		
Likely soil type: Loam or sandy soil Soil amendments: Organic compost, bentonite clay for sandy soil, soil wetting agent	<i>Botanical name</i>	<i>Common name</i>	<i>Planting density</i>
<i>Supplies you'll need to create this garden design</i>	<b>Trees</b>		
Seeds/plants	Eucalyptus torquata	Coral Gum	
Stakes	Melaleuca leucadendron	Weeping paperbark	
Organic Waterwise mulch 50-100mm thick	<b>Screening shrubs/Hedges</b>		
Slow-release fertiliser suitable for natives	Grevillea olivacea	Olive-Leaved Grevillea	1m/c
Slow-release fertiliser suitable for fruiting trees	<b>Strappy</b>		
	Anigozanthos manglesii	Kangaroo Paw	0.5m/c
	Anigozanthos humilis	Catspaw	0.5m/c
	Patersonia occidentalis	Purple Flag	0.5m/c
	<b>Medium shrubs</b>		
	Senna artemisoides	Silver cassia	0.8m/c
	Grevillea Superb	Grevillea	0.8m/c

## Mid West Native Garden Design

	<i>Groundcovers</i>		
	Kennedia prostrata	Running Postman	1m/c
	Grevillea 'Gingin Gem'	Gingin Gem	1m/c
	Hemiandra pungens	Snakebush	0.6m/c
	Eremophila glabra 'Prostrate'	Emu bush	1m/c