

# North West Arid Garden Design

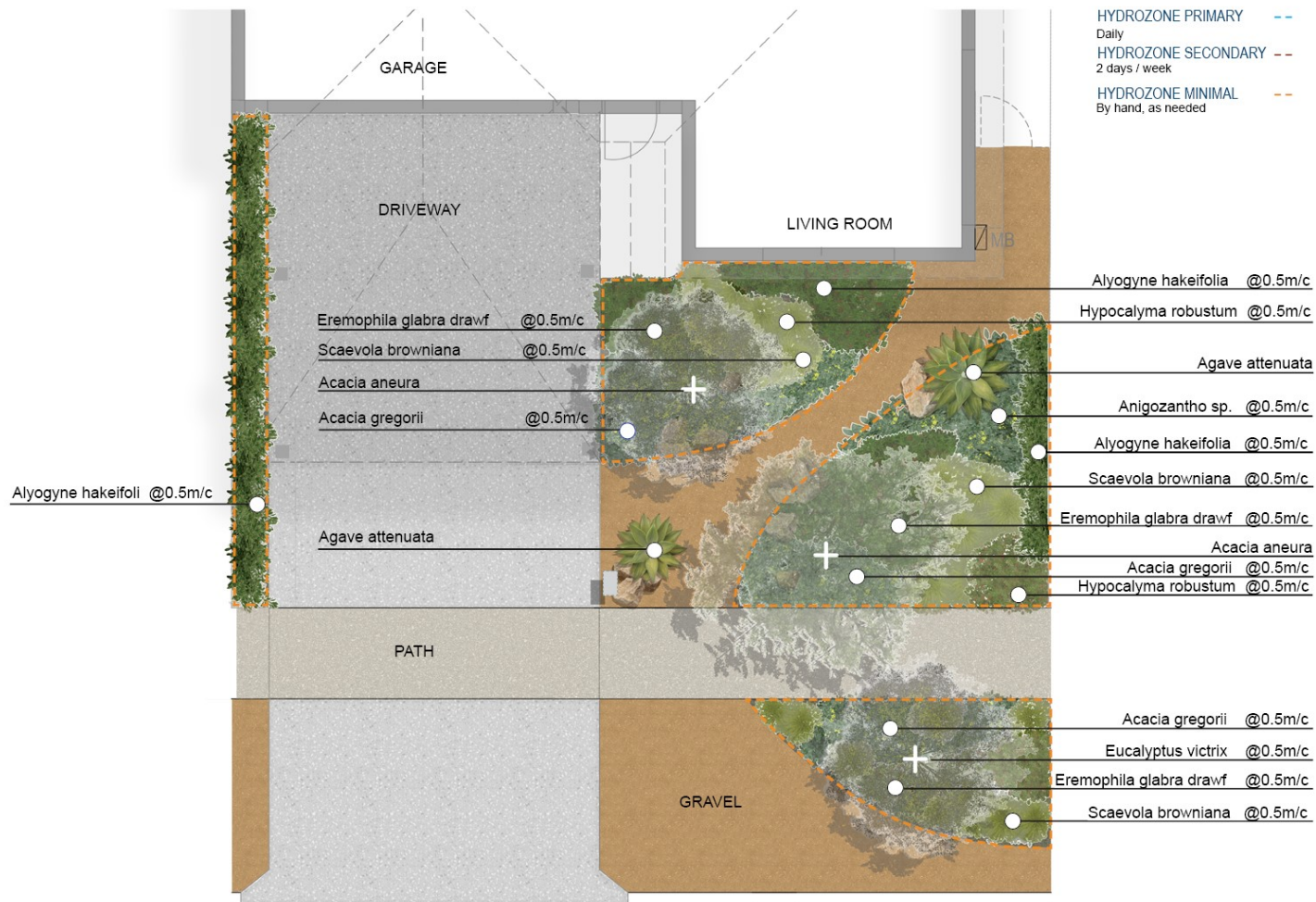

Note: m/c refers to the planting density ie 0.6m/c - leave 0.6 metre space between the centre stem of each of plant

## North West Arid Garden Design

<b>Supplies</b>	<b>Plant Directory</b>		
Likely soil type: Clay or gravels and stony Soil amendments: Organic compost, soil wetting agent and gypsum if clay content is high	<i>Botanical name</i>	<i>Common name</i>	<i>Planting density</i>
<i>Supplies you'll need to create this garden design</i>	<b><i>Trees</i></b>		
Seeds/plants	Acacia aneura	Mulga	
Stakes	Eucalyptus victrix	Smooth-barked Coolibah or Little Ghost Gum	
Organic Waterwise mulch 50-100mm thick	<b><i>Accent plants</i></b>		
Compacted gravel 75-100mm thick	Agave attenuata	Century Plant	
Edging to delineate garden beds and compacted dust	<b><i>Screening shrubs/Hedges</i></b>		
Feature boulders	Alyogyne hakeifolia	Native Hibiscus	0.5m/c
Slow-release fertiliser suitable for natives	<b><i>Medium shrubs</i></b>		
	Hypocalyma robustum 'Pink Myrtle'	Swan River Myrtle	0.5m/c
	Scaevola browniana	Fan Flower	0.5m/c
	<b><i>Groundcovers</i></b>		
	Acacia gregorii	Gregory's Wattle	0.5m/c

## North West Arid Garden Design

Eremophila glabra 'Prostrata'	Dwarf Tar Bush	0.5m/c
-------------------------------	----------------	--------

Eremophila glabra 'Prostrata'	Dwarf Tar Bush	0.5m/c
-------------------------------	----------------	--------