

Perth & South West Native Garden Design

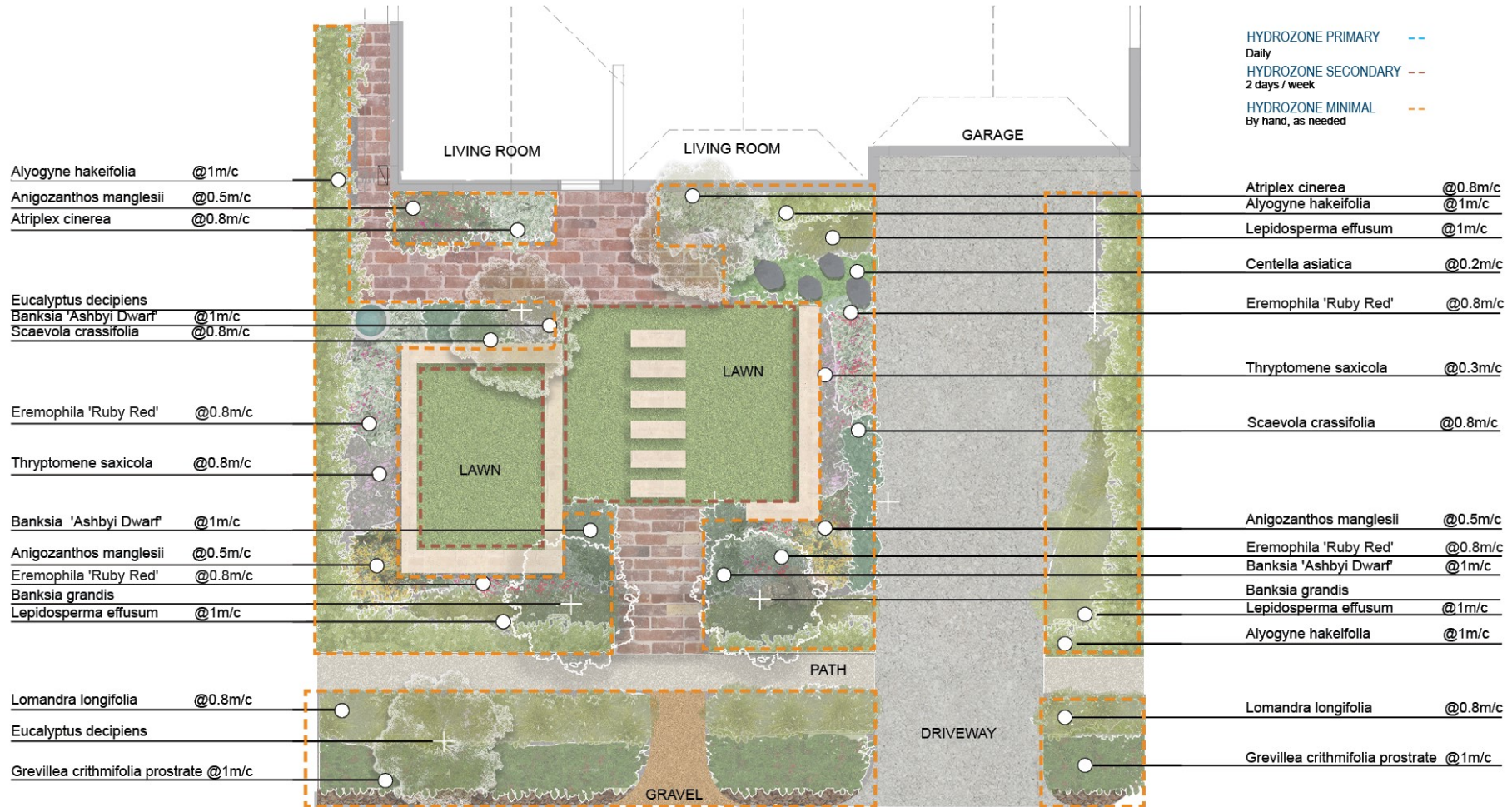

Note: m/c refers to the planting density ie 0.6m/c - leave 0.6 metre space between the centre stem of each of plant

Perth & South West Native Garden Design

Supplies	Plant Directory		
Likely soil type: Sandy soil and gravels Soil amendments: Organic compost, bentonite clay for sandy soil, soil wetting agent	<i>Botanical name</i>	<i>Common name</i>	<i>Planting density</i>
<i>Supplies you'll need to create this garden design</i>	Trees		
Seeds/plants	Banksia grandis	Bull Banksia	
Stakes	Eucalyptus decipiens	Limestone Marlock	
Organic Waterwise mulch 50-100mm thick	Cupaniopsis anacardioides	Tuckaroo	
Turf	High shrubs/Hedges		
Edging to delineate turf and garden beds	Alyogyne hakeifolia (Giord.) Alef.	Alef	1.0m/c
Compacted gravel / fines 75-100mm thick	Medium shrubs		
Stepping stones	Anigozanthos flavidus	Kangaroo Paw	0.5 m/c
Slow-release fertiliser suitable for natives	Scaevola crassifolia	Thick-leaved Fan Flower	0.8 m/c
	Lepidosperma effusum	Sword Grass	1.0 m/c
	Thryptomene saxicola	Rock Thryptomene	0.3 m/c
	Eremophila 'Ruby Red'	Emu Bush	0.6 m/c

Perth & South West Native Garden Design

	Atriplex cinerea Poir.	Grey Saltbush	0.8 m/c
	Lomandra longifolia <i>Groundcovers</i>	Spiny Headed Mat Rush	1.0 m/c
	Banksia Ashbyi Dwarf	Ashby's banksia	1.0m/c
	Grevillea crithmifolia prostrate	Grevillea	1.0m/c